

APPENDIX (1)

TOWN AND COUNTRY PLANNING ACT 1990 Town and Country Planning (Tree Preservation) (England) Regulations 2012

Bromsgrove District Council Tree Preservation Order (19) 2020 Tree/s on land at Land Side Of 37 - 38 Birkdale Avenue, Blackwell, Bromsgrove.

Bromsgrove District Council in exercise of the powers conferred on them by section 198 of the Town and Country Planning Act 1990 make the following Order—

Citation

1. This Order may be cited as **Tree Preservation Order (19) 2020**

Interpretation

- 2.— (1) In this Order “the authority” means Bromsgrove District Council.
- (2) In this Order any reference to a numbered section is a reference to the section so numbered in the Town and Country Planning Act 1990 and any reference to a numbered regulation is a reference to the regulation so numbered in the Town and Country Planning (Tree Preservation)(England) Regulations 2012.

Effect

- 3.— (1) Subject to article 4, this Order takes effect provisionally on the date on which it is made.
- (2) Without prejudice to subsection (7) of section 198 (power to make tree preservation orders) or subsection (1) of section 200 (tree preservation orders: Forestry Commissioners) and, subject to the exceptions in regulation 14, no person shall—
 - (a) cut down, top, lop, uproot, wilfully damage, or wilfully destroy; or
 - (b) cause or permit the cutting down, topping, lopping, uprooting, wilful damage or wilful destruction of,

any tree specified in the Schedule to this Order except with the written consent of the authority in accordance with regulations 16 and 17, or of the Secretary of State in accordance with regulation 23, and, where such consent is given subject to conditions, in accordance with those conditions.

Application to trees to be planted pursuant to a condition

4. In relation to any tree identified in the first column of the Schedule by the letter “C”, being a tree to be planted pursuant to a condition imposed under paragraph (a) of section 197 (planning permission to include appropriate provision for preservation and planting of trees), this Order takes effect as from the time when the tree is planted.

Dated this 19th day of November 2020

Signed on behalf of Bromsgrove District Council



Authorised by the Council to sign in that behalf

First Schedule

Trees specified individually

(encircled in black on the map)

<u>No. on Map</u>	<u>Description</u>	<u>NGR</u>	<u>Situation</u>
T1	Silver Birch	399322, 272093	On land between the front of the properties
T2	Oak	399343, 272107	Land Side of 37 Birkdale Avenue
T3	Oak	399347, 272112	Land Side of 37 Birkdale Avenue

Trees specified by reference to an area

(within a dotted black line on the map)

<u>No. on Map</u>	<u>Description</u>	<u>NGR</u>	<u>Situation</u>
-------------------	--------------------	------------	------------------

NONE

Groups of Trees

(within a broken black line on the map)

<u>No. on Map</u>	<u>Description</u>	<u>NGR</u>	<u>Situation</u>
G1	4 x Silver Birch	399354, 272112	Land side of 37 Birkdale Avenue

Woodlands

(within a continuous black line on the map)

<u>No. on Map</u>	<u>Description</u>	<u>NGR</u>	<u>Situation</u>
W1	Mixed Species Ash, Sycamore, Silver Birch, Oak, Willow, Hawthorn	399308, 272063	Land side of 37-38 Birkdale Avenue

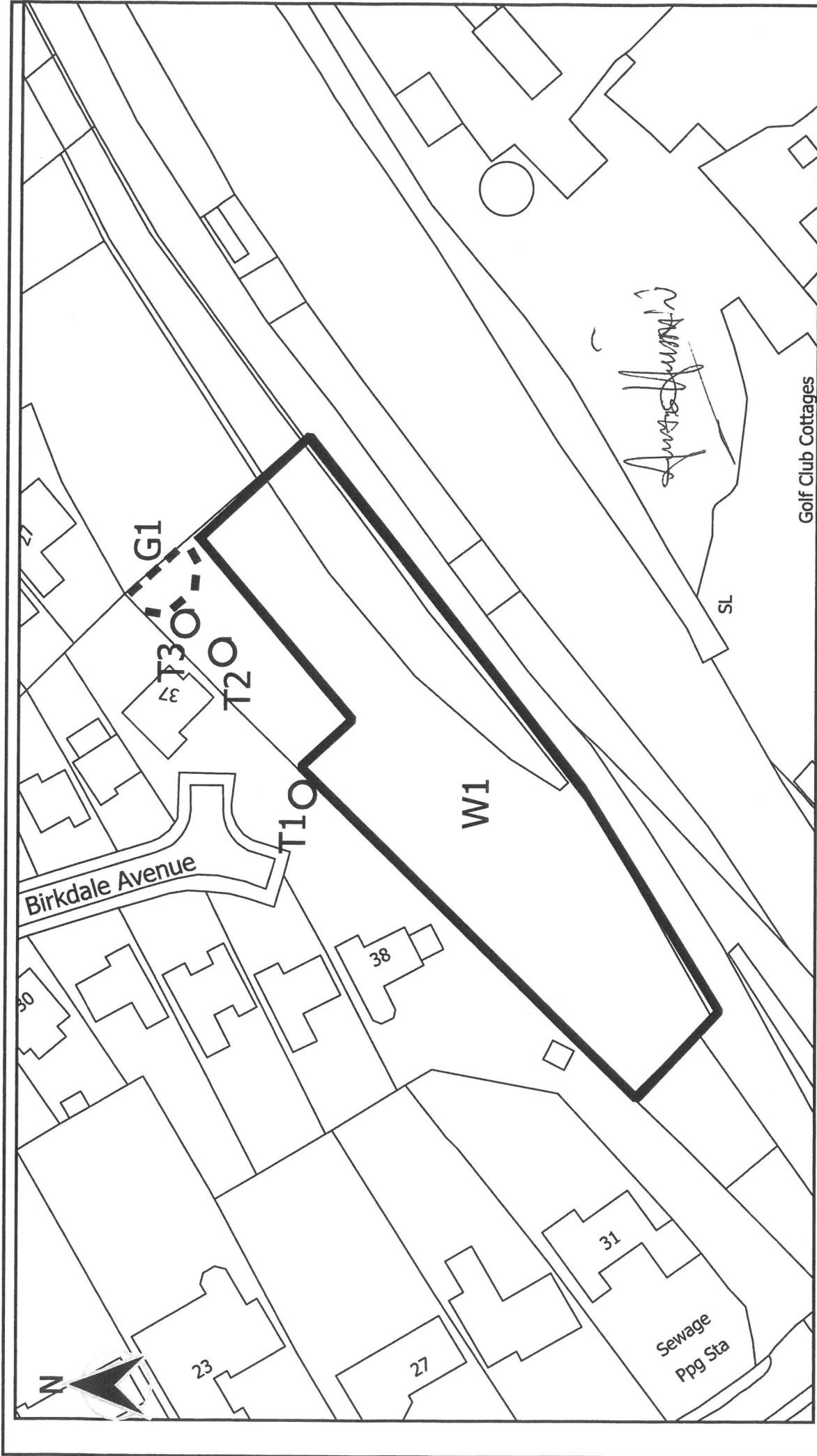

Environmental Services
 Town Hall
 Walter Stranz Square
 Redditch
 Worces B98 8AH

Bromsgrove District Council TPO (19) 2020
 Project: Council TPO (19) 2020
 Drawing: Avenue, Blackwell

Bromsgrove District Council
www.bromsgrove.gov.uk



REDDITCH BOROUGH COUNCIL
 making difference
www.redditchbc.gov.uk

@ Crown copyright and database rights
 2020
 Ordnance Survey 100023252

Drawn: G.B.
 Scale: 1/800 @ A4
 Date: 6/11/2020
 Drawing No.: 1

